

# R22XX Series Punched Panels

*Punched Panels with  
Cable Support Bar*

Punched rack panels with integrated cable support bar.

The panel has a lacing bar for cable support and cable management.

The panel also as an ID strip for connector identification.

Available with punched panels for D-Series Chassis connectors (R2269 Series) or BNC Connectors (R2280 Series)

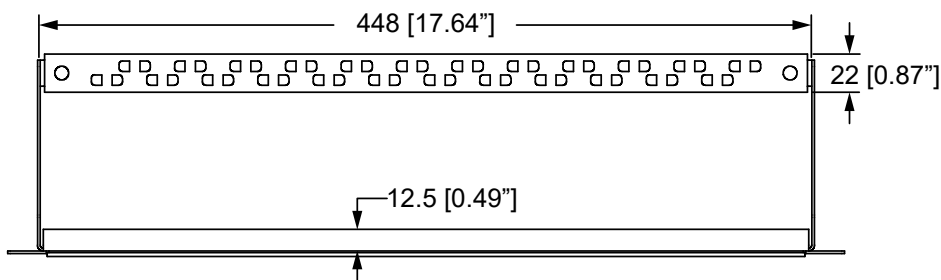

## 1U Panels

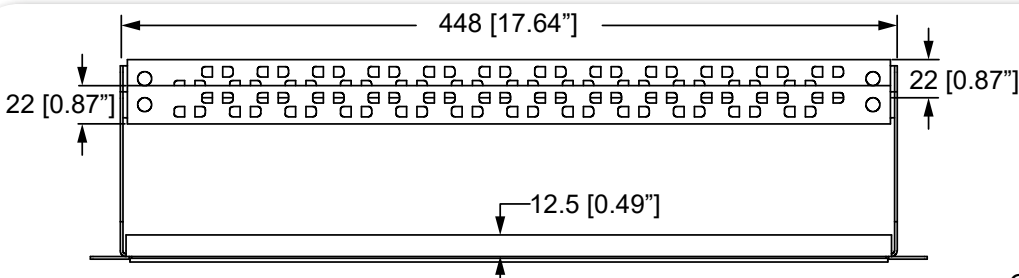
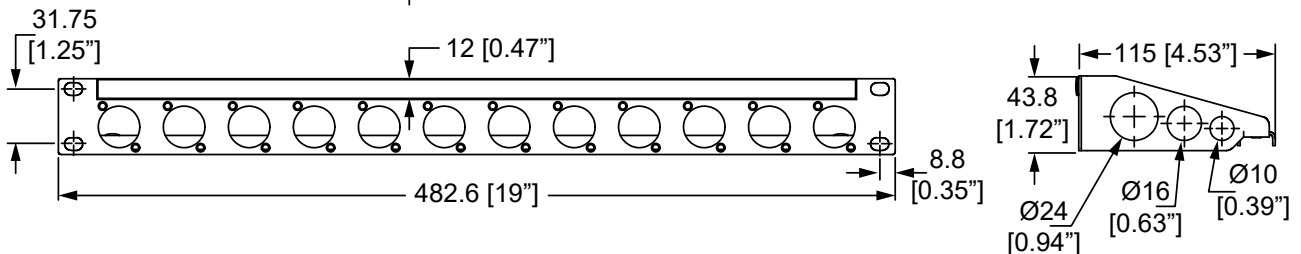

## 2U Panels

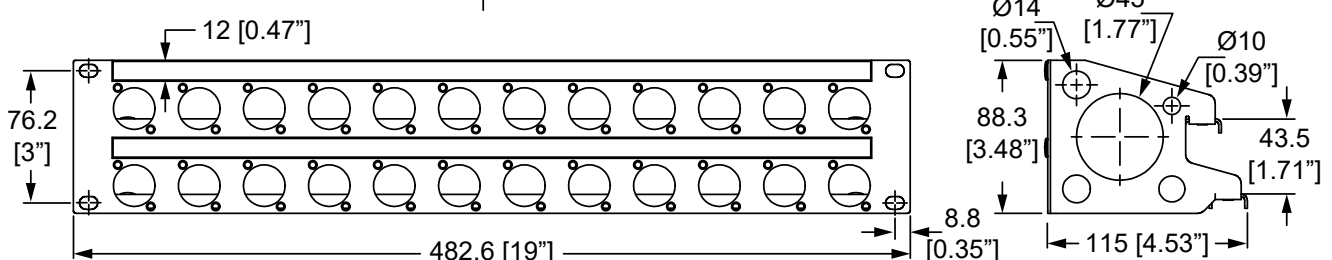

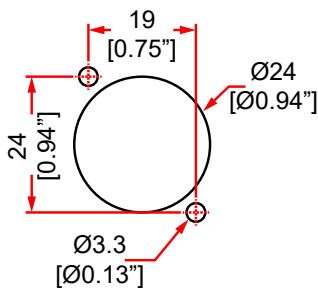

D-Series Hole Patterns

# R2269 Series Panels punched for D-series connector chassis

## R2269/1UK-08

U Size:	1 Unit
Punch Pattern	8 Neutrik D-Series
Weight:	0.67kg / 1.47lb

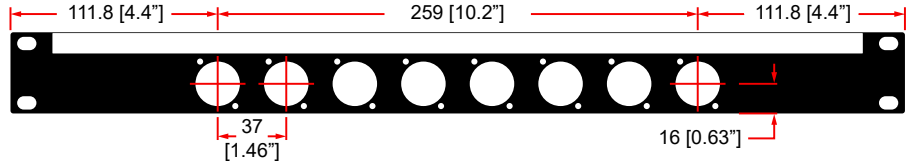

## R2269/1UK-12

U Size:	1 Unit
Punch Pattern	12 Neutrik D-Series
Weight:	0.65kg / 1.44lb

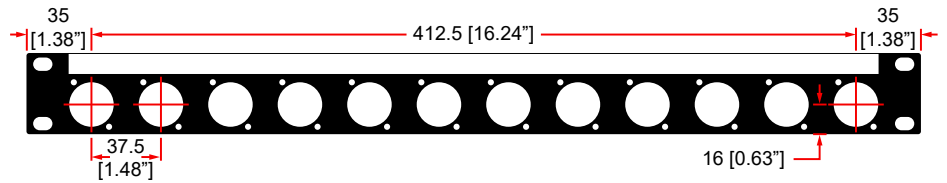

## R2269/1UK-16

U Size:	1 Unit
Punch Pattern	16 Neutrik D-Series
Weight:	0.65kg / 1.43lb

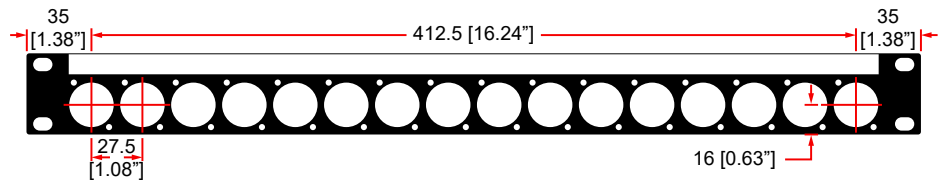

## R2269/2UK-16

U Size:	2 Units
Punch Pattern	16 Neutrik D-Series
Weight:	1.26kg / 2.77lb

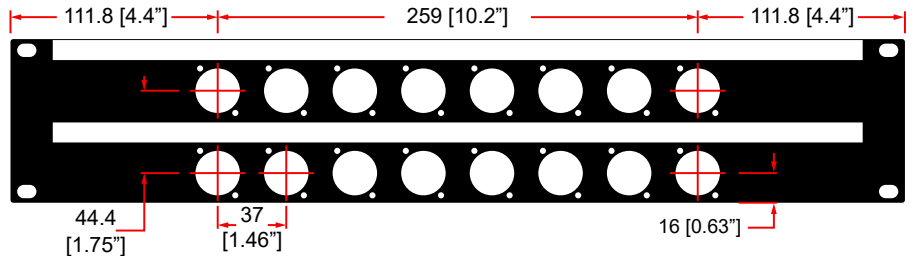

## R2269/2UK-24

U Size:	2 Units
Punch Pattern	24 Neutrik D-Series
Weight:	1.2kg / 2.66lb

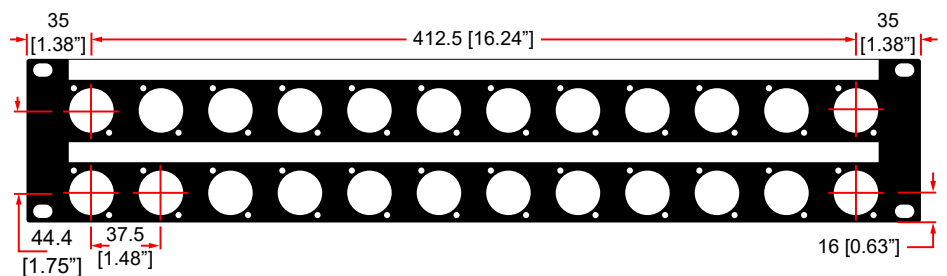

## R2269/2UK-32

U Size:	2 Units
Punch Pattern	32 Neutrik D-Series
Weight:	1.15kg / 2.54lb

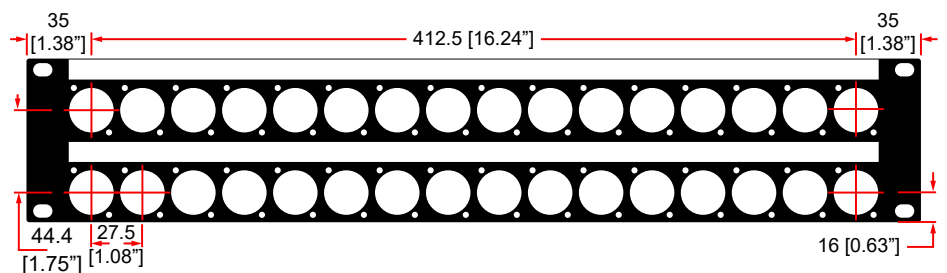

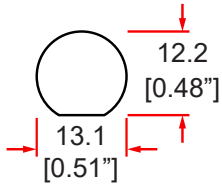

BNC Hole Patterns

# R2280 Series Panels punched for BNC connectors

## R2280-1UK-16

U Size:	1 Unit
Punch Pattern	16 BNC Connectors
Weight:	0.67kg / 1.47lb

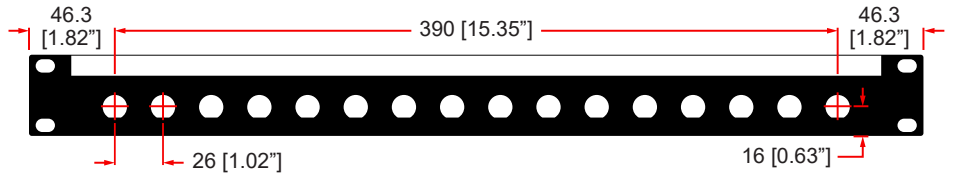

## R2280-1UK-20

U Size:	1 Unit
Punch Pattern	20 BNC Connectors
Weight:	0.65kg / 1.44lb

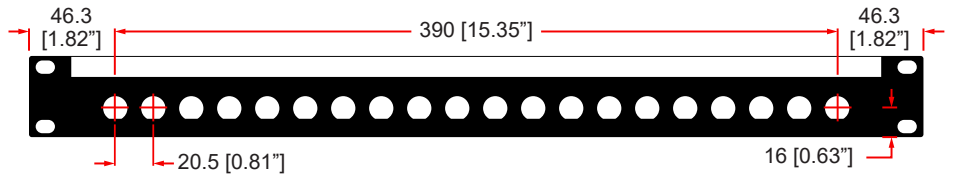

## R2280-1UK-24

U Size:	1 Unit
Punch Pattern	24 BNC Connectors
Weight:	0.65kg / 1.43lb

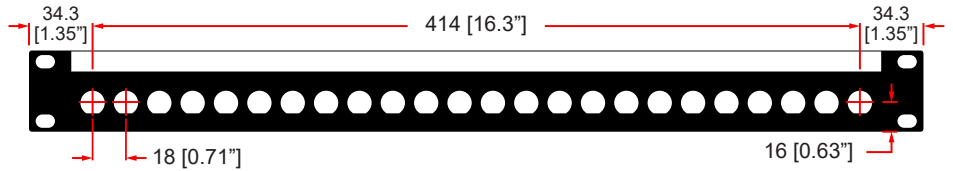

## R2280-2UK-32

U Size:	2 Units
Punch Pattern	32 BNC Connectors
Weight:	1.26kg / 2.77lb

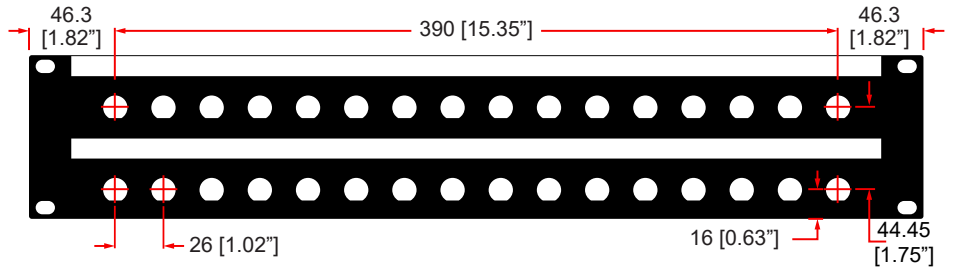

## R2280-2UK-40

U Size:	2 Units
Punch Pattern	40 BNC Connectors
Weight:	1.2kg / 2.66lb

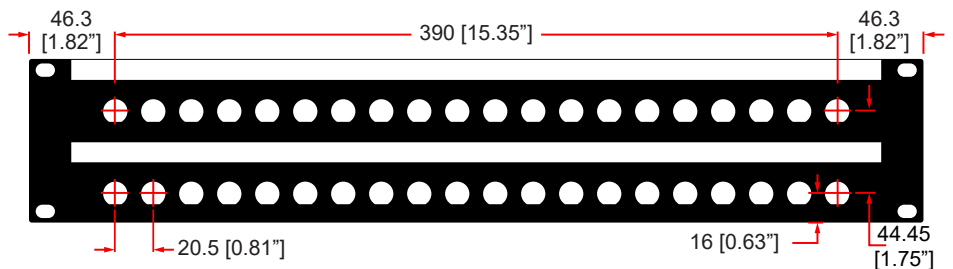

## R2280-2UK-48

U Size:	2 Units
Punch Pattern	48 BNC Connectors
Weight:	1.15kg / 2.54lb

